

# Operation Guide

Measure with precision, monitor with ease

Before testing, ensure a stable ambient temperature, and that your hands are clean, dry, and warm.

## 1 Insert the test strip to power on the meter

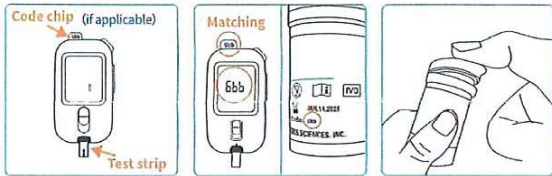

Insert the code chip and the test strip. Ensure it matches the display. Keep the test strip container tightly closed.

### NOTE:

Code chip (when applicable) is only required when using a new box of test strips. Please make sure that the test strip is fully inserted.

## 3 Proper operations for precise results

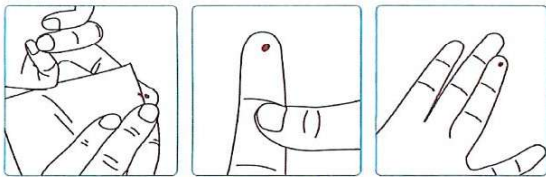

Wipe off the first drop of blood. Gently press your finger; avoid squeezing. Use the second drop for better accuracy.

### NOTE:

If blood is insufficient or clots form, collect a new sample. Avoid excessive squeezing to prevent interference from interstitial fluid.

## 5 View results and dispose of waste



The countdown indicates testing in progress. The results appear on the screen at the end of the countdown. Remove the strip.

### NOTE:

Place the device on a flat surface during the countdown; dispose of waste properly.

## 2 Disinfect fingertips to collect a blood sample

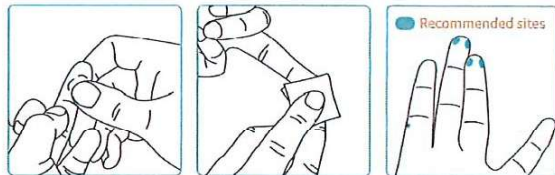

Wash hands, then gently massage to improve circulation. Disinfect fingertips and leave to dry. Collect the blood sample from recommended sites.

### NOTE:

Wash hands with warm water, lower your arm, or massage your finger to enhance blood flow.

## 4 Load the blood sample and wait for results

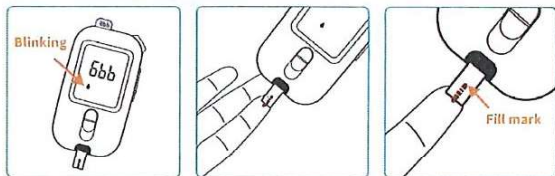

Wait for the blinking sample icon. Bring the blood drop into contact with the sample inlet. Fill the strip completely in one attempt.

### NOTE:

The sample inlet is at the bottom edge of the test strip.



602-00038-A4



# Tips for blood collection devices

Note: Operation steps may vary depending on the blood collection device used.  
Please refer to the instructions for your specific product.

## Reusable blood collection pen with single-use disposable needle for individual use

### Before testing

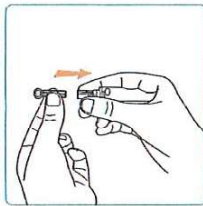

Unscrew the pen cap; insert the needle until it is fully seated.

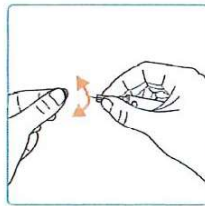

Twist off the needle cap and set aside.

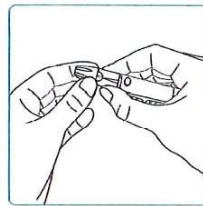

Place the pen cap back and set puncture depth.

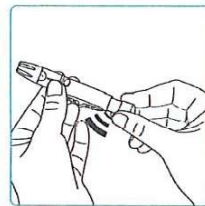

Pull out the tail handle and set aside.

### Collect sample



Press the pen against the fingertip, then press the launch button.

### After testing

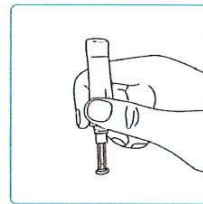

Insert the blood collection needle back into the needle cap.



Safely discard the needle.

## Disposable blood lancet

### Before testing

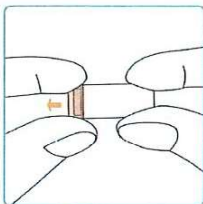

Remove the protective cap.

### Collect blood sample

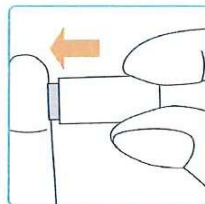

Position the lancet against the fingertip and press.

### After testing

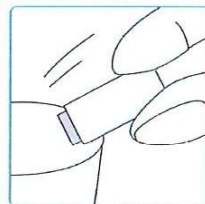

Safely discard the lancet.